

LED Module JE-001R-MN Specification

Description

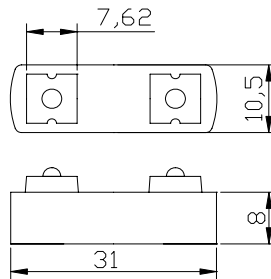

Dimensions (mm)



Notes:

1. All dimensions are in millimeters.
2. Tolerance is ± 0.25 unless otherwise noted.
3. Specifications are subject to change without notice.
4. Lead spacing is measured where the lead emerge package.

Specification

Part number	Description	Lens Type	Intensity(mcd)@20mA		Viewing Angle
			Min.	Typ.	2 θ 1/2
JE-001R-MN	Ultra Bright Red	Water clear	1000 x2	1400 x2	100° \pm 5

Electrical / Optical characteristics at $T_A=25^\circ\text{C}$

Parameter	Typ.	Max.	Units
Dominate Wavelength	625	630	V
Forward Voltage	12	12.2	mA
Standing Current	36	38	mA
Power consumption	432	465	mW
Operating temperature	-50°C To +80°C		

LED Module JE-001R-MN Specification

LED Typical Optical/Electrical Characteristics Curves

($T_a=25^\circ\text{C}$ Unless Otherwise Noted)

Forward Current vs. Ambient Temperature Relative Intensity vs. Ambient Temperature

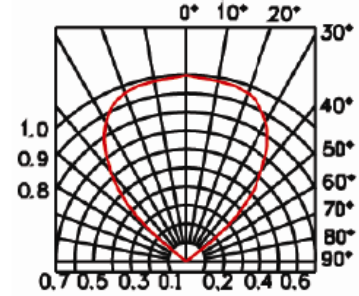
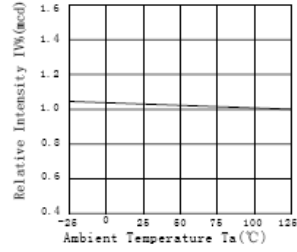
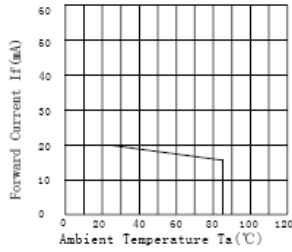

Forward Current vs. Forward Voltage

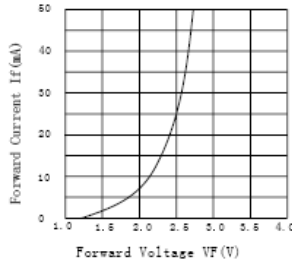

Forward Voltage vs. Ambient Temperature

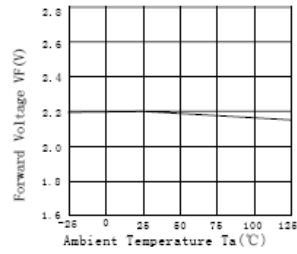

Luminous Spectrum ($T_a=25^\circ\text{C}$) SPECTRAL RADIANCE

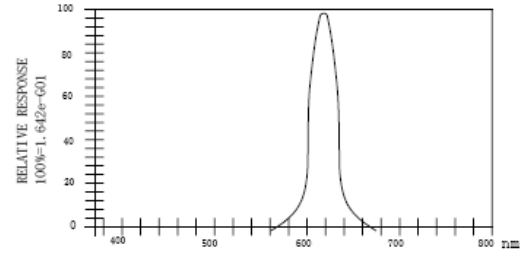

LED Module JE-002G-MN Specification

Description



Dimensions (mm)

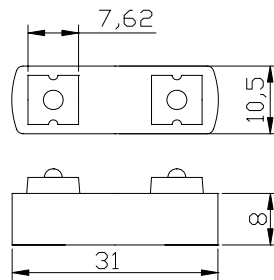

Notes:

1. All dimensions are in millimeters.
2. Tolerance is ± 0.25 unless otherwise noted.
3. Specifications are subject to change without notice.
4. Lead spacing is measured where the lead emerge package.

Specification

Part number	Description	Lens Type	Intensity(mcd)@20mA		Viewing Angle
			Min.	Typ.	2 θ 1/2
JE-004G-02	Ultra Bright Green	Water clear	1100x 2	1250 x2	100° \pm 5

Electrical / Optical characteristics at T_A=25°C

Parameter	Typ.	Max.	Units
Dominant Wavelength	515	520	nm
Forward Voltage	12	12.2	mA
Standing Current	18	20	mA
Power consumption	210	240	mW
Operating temperature	-50°C To +80°C		

LED Module JE-002G-MN Specification

LED Typical Optical/Electrical Characteristics Curves

($T_a=25^\circ\text{C}$ Unless Otherwise Noted)

Forward Current vs. Ambient Temperature Relative Intensity vs. Ambient Temperature

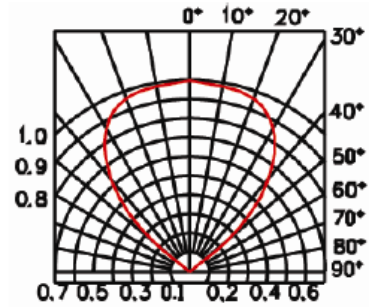
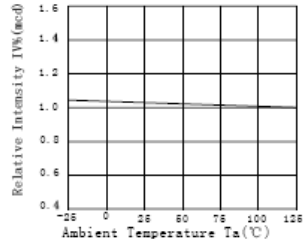
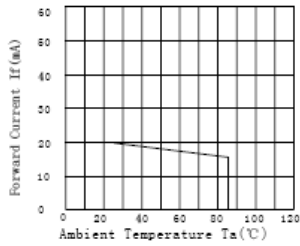

Forward Current vs. Forward Voltage

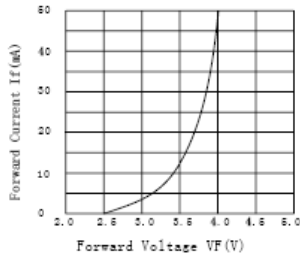

Forward Voltage VF(V) vs. Ambient Temperature

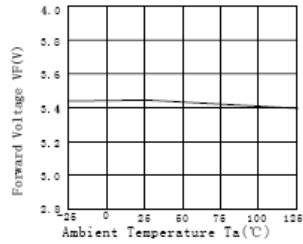

Luminous Spectrum ($T_a=25^\circ\text{C}$) SPECTRAL RADIANCE

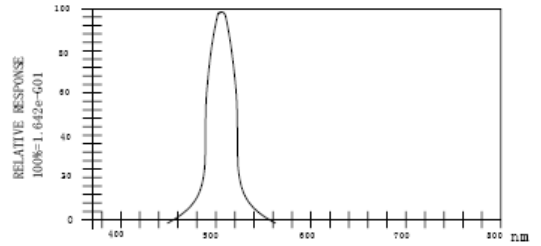

LED Module JE-003B-MN Specification

Description



Dimensions (mm)

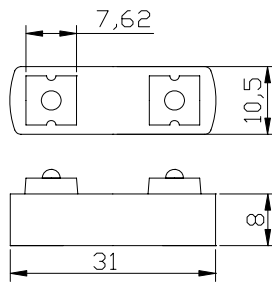

Notes:

1. All dimensions are in millimeters.
2. Tolerance is ± 0.25 unless otherwise noted.
3. Specifications are subject to change without notice.
4. Lead spacing is measured where the lead emerge package.

Specification

Part number	Description	Lens Type	Intensity(mcd)@20A		Viewing Angle
			Min.	Typ.	2 θ 1/2
JE-003B-MN	Ultra Bright Blue	Water clear	500x 2	700 x2	100° \pm 5

Electrical / Optical characteristics at T_A=25°C

Parameter	Typ.	Max.	Units
Dominate Wavelength	465	470	nm
Forward Voltage	12	12.2	mA
Standing Current	18	20	mA
Power consumption	210	240	mW
Operating temperature	-50°C To +80°C		

LED Module JE-003B-MN Specification

LED Typical Optical/Electrical Characteristics Curves

($T_a=25^\circ\text{C}$ Unless Otherwise Noted)

Forward Current vs. Ambient Temperature Relative Intensity vs. Ambient Temperature

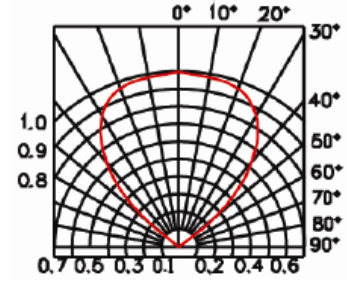
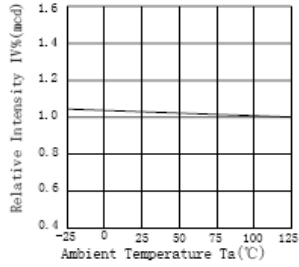
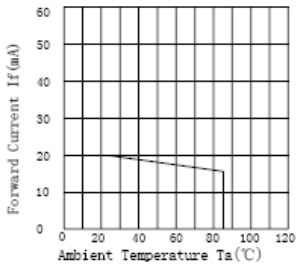

Forward Current vs. Forward Voltage

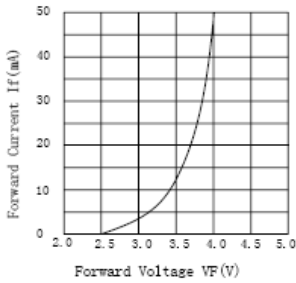

Forward Voltage vs. Ambient Temperature

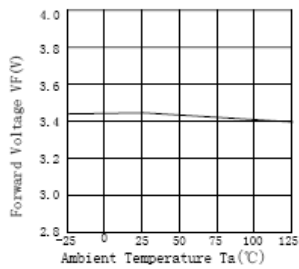

Luminous Spectrum ($T_a=25^\circ\text{C}$) SPECTRAL RADIANCE

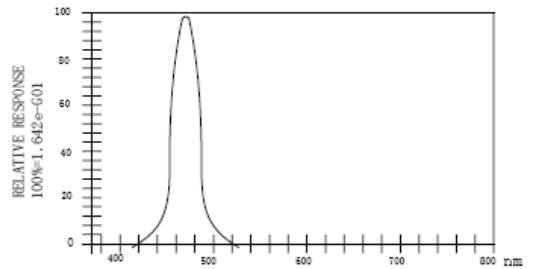

LED Module JE-004W-MN Specification

Description



Dimensions (mm)

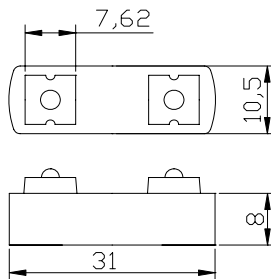

Notes:

1. All dimensions are in millimeters.
2. Tolerance is ± 0.25 unless otherwise noted.
3. Specifications are subject to change without notice.
4. Lead spacing is measured where the lead emerge package.

Specification

Part number	Description	Lens Type	Intensity(mcd)@20mA		Viewing Angle
			Min.	Typ.	2 θ 1/2
JE-004W-MN	white	Water Clear	1200x 2	1400 x2	120° \pm 5

Electrical / Optical characteristics at $T_A=25^\circ\text{C}$

Parameter	Typ.	Max.	Units
Color temperature	9000	12000	K
Forward Voltage	12	12.2	mA
Standing Current	18	20	mA
Power consumption	210	240	mW
Operating temperature	-50°C To +80°C		

LED Module JE-004W-MN Specification

LED Typical Optical/Electrical Characteristics Curves

($T_a=25^\circ\text{C}$ Unless Otherwise Noted)

Forward Current vs. Ambient Temperature Relative Intensity vs. Ambient Temperature

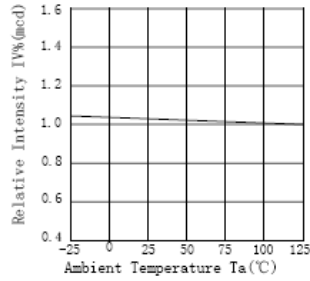
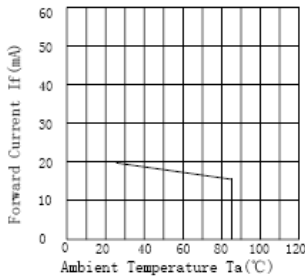

Forward Current vs. Forward Voltage

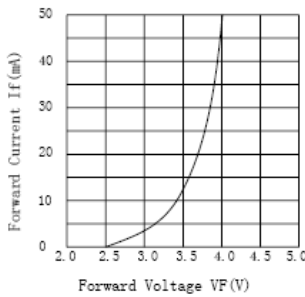

Forward Voltage vs. Ambient Temperature

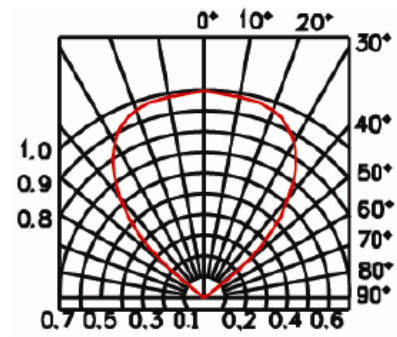
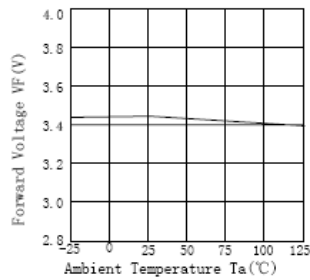

LED Module JE-005A-MN Specification

Description



Dimensions (mm)

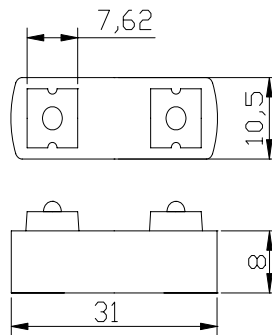

Notes:

1. All dimensions are in millimeters.
2. Tolerance is ± 0.25 unless otherwise noted.
3. Specifications are subject to change without notice.
4. Lead spacing is measured where the lead emerge package.

Specification

Part number	Description	Lens Type	Intensity(mcd)@20mA		Viewing Angle
			Min.	Typ.	2 θ 1/2
JE-005A-MN	Ultra Bright Yellow	Water clear	850x 2	1000 x2	100 \pm 5

Electrical / Optical characteristics at T_A=25 $^{\circ}$ C

Parameter	Typ.	Max.	Units
Dominate Wavelength	590	595	V
Forward Voltage	12	12.2	mA
Standing Current	30	32	mA
Power consumption	360	390.4	mW
Operating temperature	-50 $^{\circ}$ C To +80 $^{\circ}$ C		

LED Module JE-005A-MN Specification

LED Typical Optical/Electrical Characteristics Curves

($T_a=25^\circ\text{C}$ Unless Otherwise Noted)

Forward Current vs. Ambient Temperature Relative Intensity vs. Ambient Temperature

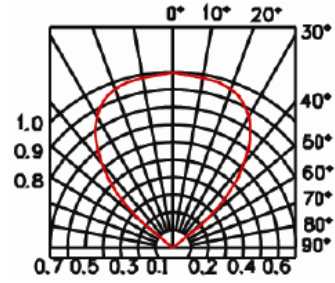
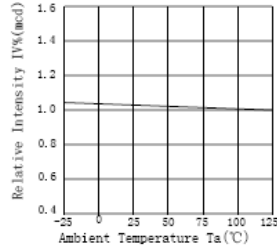
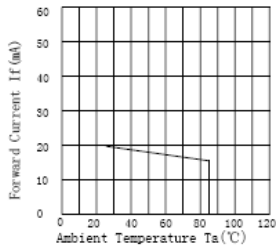

Forward Current vs. Forward Voltage

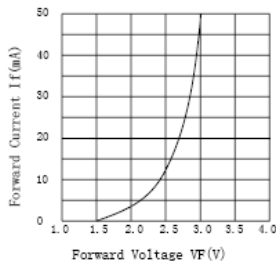

Forward Voltage vs. Ambient Temperature

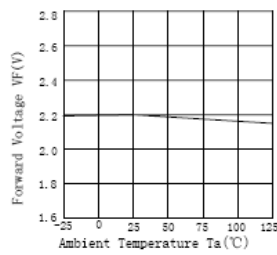

Luminous Spectrum ($T_a=25^\circ\text{C}$) SPECTRAL RADIANCE

